

# ZACHRY ENGINEERING EDUCATION COMPLEX

---

FACILITY MAP



**ENGINEERING**  
TEXAS A&M UNIVERSITY



The new Zachry Engineering Education Complex is a completely modernized and expanded facility. The original Zachry building was dedicated in 1972 and served the college well for many years. Now at 525,000 sq. ft. and dedicated solely to undergraduate engineering education, it is the largest academic building on the Texas A&M campus.

The complex will revolutionize the way we deliver education to our undergraduate students. It will be a departure from the traditional classroom and lecture hall and focus on student-centered design to optimize modern learning techniques and technology.



**ENGINEERING**  
TEXAS A&M UNIVERSITY

Download the EngiNEAR ME app for fully accessible navigation around the ZACH. Available on the App Store and Google Play.





# THE ENGINEERING QUAD (E-QUAD)

## 50 Engineering Equations

Throughout the E-Quad, you can find 50 favorite equations engraved in the pavement that were selected by our students, faculty, staff and former students.

Zachry Engineering Education Complex

Dwight Look Engineering Building

**How to build  
a sphere  
out of cubes**  
*By Olafur Eliasson*

Wisembaker Engineering Building

Civil Engineering Lab Building

Joe C. Richardson Petroleum Engineering Building

H.J. (Bill) and Reta Haynes Engineering Building

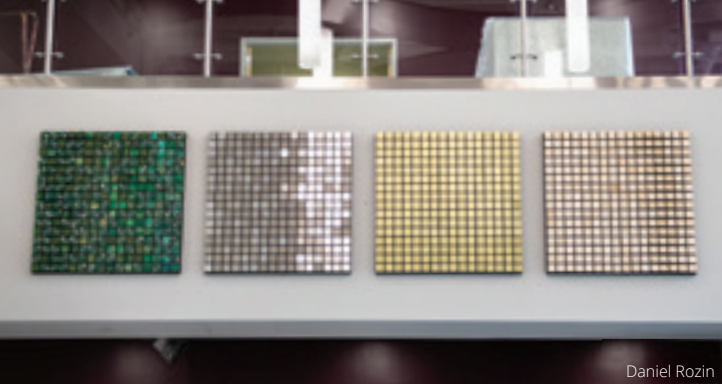

Daniel Rozin

## INTERSECTION OF ART & ENGINEERING

The College of Engineering integrated an art program within the Zachry Engineering Education Complex to encourage creativity, innovation and promote cross-disciplinary initiatives in education and research. The art program entails site-specific works of art created by visionary artists, who conceptually draw inspiration from science, technology, engineering and mathematics. The goal of The College of Engineering art program is to engage the students, faculty and alumni by inspiring exploration, inventiveness and enterprise.



Jay Shinn

# ENGINEERING ART COLLECTION

## IN THE ZACHRY ENGINEERING EDUCATION COMPLEX

This collection celebrates the intersection of creativity and innovation through art and engineering. The College of Engineering has commissioned site-specific, privately-funded works of art that reflect the interdisciplinary fields of engineering.

A university committee selected 10 visionary artists from more than 100 candidates to be included in the art collection within the Zachry Engineering Education Complex. The selected artists draw inspiration from science, technology, engineering and mathematics. The collection promotes innovation and discovery of science and engineering by:

- Encouraging excellence, innovation and cross-disciplinary initiatives in engineering education
- Providing national and international leadership in engineering education
- Encouraging and supporting opportunities for students to grow beyond their chosen disciplines.





Copyright: How to build a sphere out of squares 2018, Olafur Eliasson for Texas A&M University — Photo: Studio Eliasson



Lyndi Sales



Rusty Scruby

## Engineering Art Collection

### LEVEL 1:

#### How to build a sphere out of cubes

By Olafur Eliasson

*Mixed Media Sculpture (located in E-Quad)*

#### Smoke Painting #44

By Rosemarie Fiore

*Color Smoke Firework Residue on Paper*

#### A-Gadda-Da-Vida

By Jay Shinn

*Wall Painting with Choreographed Projected Color Sequence, Repeating Loop*

### LEVEL 2:

#### Pulse

By Daniel Canogar

*Screens, Electronic Components, Video Contents*

#### Prototype for Stellar Interloper (Silver Surfer)

By Iñigo Manglano-Ovalle

*Carbon fiber and aluminum alloy-foil*

#### What it Takes to Make

By Daniel Rozin

*1024 motors, motion sensors, control electronics, custom firmware, printed circuits, stainless steel, brass and wood*

#### Shapeshifting to Transcend Limbo & Transcending Realms: Chaos and Flow, Love and Fear

By Lyndi Sales

*Mirrored acrylic, dichroic acrylic, and aluminum*

#### Lathocyte

By Andy Vogt

*Salvaged Lath*

### LEVEL 3:

#### Transparent Data

By Laurie Frick

*Fused glass and mild steel*

### LEVEL 4:

#### Infinitesimals

By Rusty Scruby

*Photographic reconstruction on aluminum*

# ZACHRY ENGINEERING EDUCATION COMPLEX



## FACILITY MAP

Download the EngiNEAR ME app for fully accessible navigation around the ZACH. Available on the App Store and Google Play.



# el 1

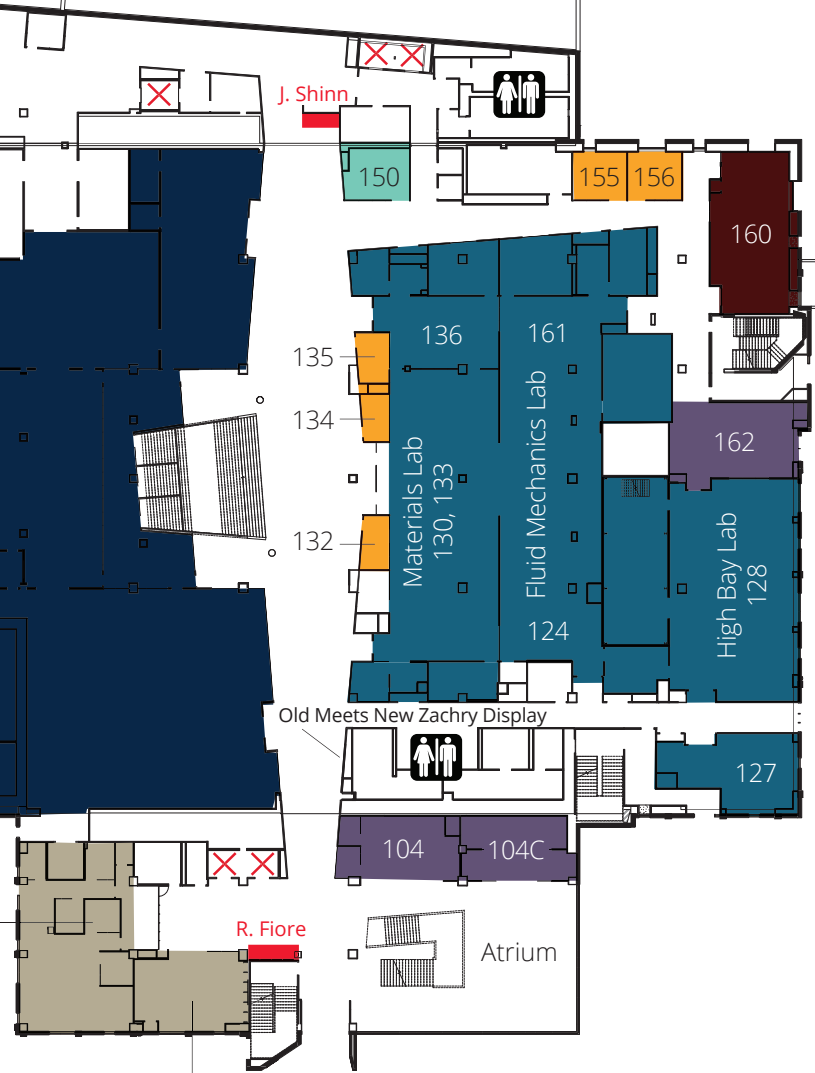



# Level 2

- ✕ Elevators
- Design Studios
- Learning Studios
- Study/Huddle Spaces
- Open Study Areas
- Labs
- Learning Resource Center
- Event Space
- College of Engineering Offices
- Engineering Art Collection





## Level 3



# Level 4



# Level 5

- ✕ Elevators
- Learning Studios
- Study/Huddle Spaces
- Open Study Areas
- Labs
- College of Engineering Offices
- Meeting Rooms
- Engineering Art Collection

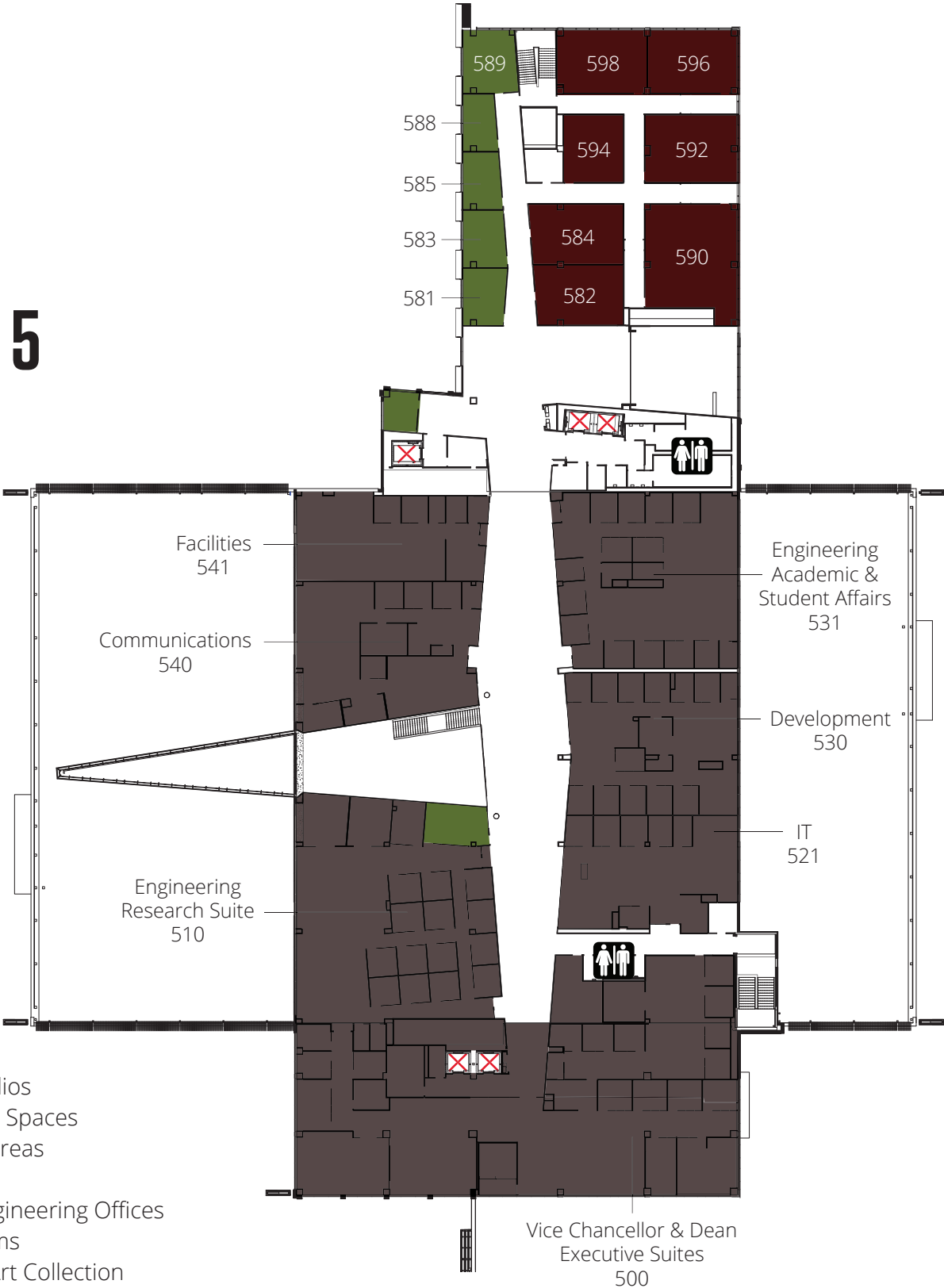



# ENGINEERING @ TEXAS A&M

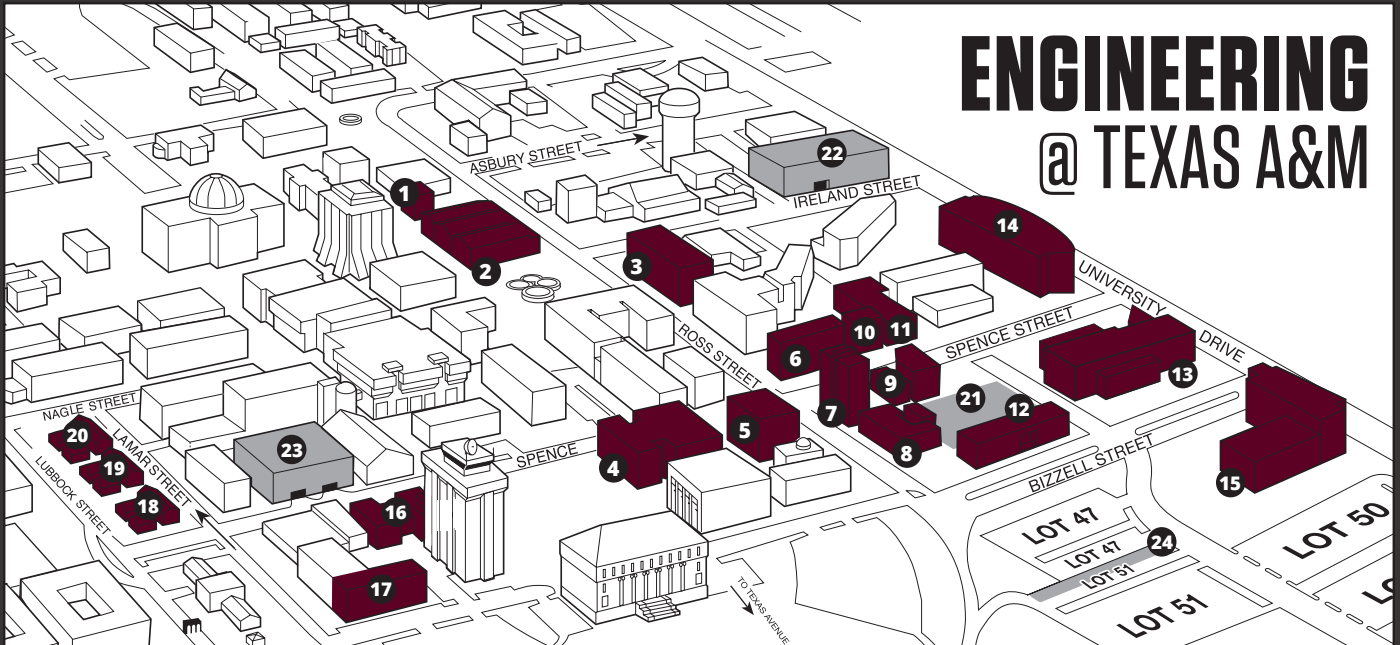

**1 Fermier Hall (FERM)**

466 Ross Street, College Station, TX 77843

**2 Thompson Hall (THOM)**

510 Ross Street, College Station, TX 77843

**3 Reed McDonald Building (RDMC) / Graphics Services Building**

575 Ross Street, College Station, TX 77843

**4 Scoates Hall (SCTS)**

333 Spence Street, College Station, TX 77843

**5 Harvey R. Bright Building (HRBB)**

710 Ross Street, College Station, TX 77843

**6 Doherty Building (DRTY)**

242 Spence Street, College Station, TX 77843

**7 Joe C. Richardson Petroleum Engineering Building (RICH)**

245 Spence Street, College Station, TX 77843

**8 H.J. (Bill) and Reta Haynes Engineering Building (HEB)**

727 Ross Street, College Station, TX 77843

**9 Dwight Look Engineering Building (DLEB)**

199 Spence Street, College Station, TX 77843

**10 Mechanical Engineering Office Building (MEOB)**

202 Spence Street, College Station, TX 77843

**11 James J. Cain '51 Building (ENPH)**

180 Spence Street, College Station, TX 77843

**12 Wisenbaker Engineering Building (WEB)**

188 Bizzell Street, College Station, TX 77843

**13 Zachry Engineering Education Complex (ZACH)**

125 Spence Street, College Station, TX 77843

**14 Jack E. Brown Chemical Engineering Building (CHEN)**

100 Spence Street, College Station, TX 77843

**15 Emerging Technologies Building (ETB)**

101 Bizzell Street, College Station, TX 77843

**16 AI Engineering Building (AIEN)**

423 Spence Street, College Station, TX 77843

**17 Teague Research Center (TEAG)**

735 Lamar Street, College Station, TX 77843

**ENGINEERING ACTIVITIES BUILDINGS:**

*Located on Lamar Street between Spence Street and Nagle Street.*

**18 Engineering Activities Building A (EABA)**

646 Lamar Street, College Station, TX 77843

**19 Engineering Activities Building B (EABB)**

620 Lamar Street, College Station, TX 77843

**20 Engineering Activities Building C (EABC)**

588 Lamar Street, College Station, TX 77843

**21 Engineering Quad (E-Quad)**

**VISITOR PARKING:**

**22 Northside Parking Garage (NSPG)**

104 Ireland Street, College Station, TX 77843

**23 Central Parking Garage (CCPG)**

450 Spence Street, College Station, TX 77843

**24 Lot 51 Paid Visitor Parking**

Polo Road, College Station, TX 77843