

ZACHRY ENGINEERING EDUCATION COMPLEX

FACILITY MAP



ENGINEERING
TEXAS A&M UNIVERSITY



The new Zachry Engineering Education Complex is a completely modernized and expanded facility. The original Zachry building was dedicated in 1972 and served the college well for many years. Now at 525,000 sq. ft. and dedicated solely to undergraduate engineering education, it is the largest academic building on the Texas A&M campus.

The complex will revolutionize the way we deliver education to our undergraduate students. It will be a departure from the traditional classroom and lecture hall and focus on student-centered design to optimize modern learning techniques and technology.



ENGINEERING
TEXAS A&M UNIVERSITY

Download the EngiNEAR ME app for fully accessible navigation around the ZACH.



THE ENGINEERING QUAD (E-QUAD)

50 Engineering Equations

Throughout the E-Quad, you can find 50 favorite equations engraved in the pavement that were selected by our students, faculty, staff and former students.

Zachry Engineering Education Complex

Dwight Look Engineering Building

How to build a sphere out of cubes
By Olafur Eliasson

Wisembaker Engineering Building

Civil Engineering Lab Building

Joe C. Richardson Petroleum Engineering Building

H.J. (Bill) and Reta Haynes Engineering Building

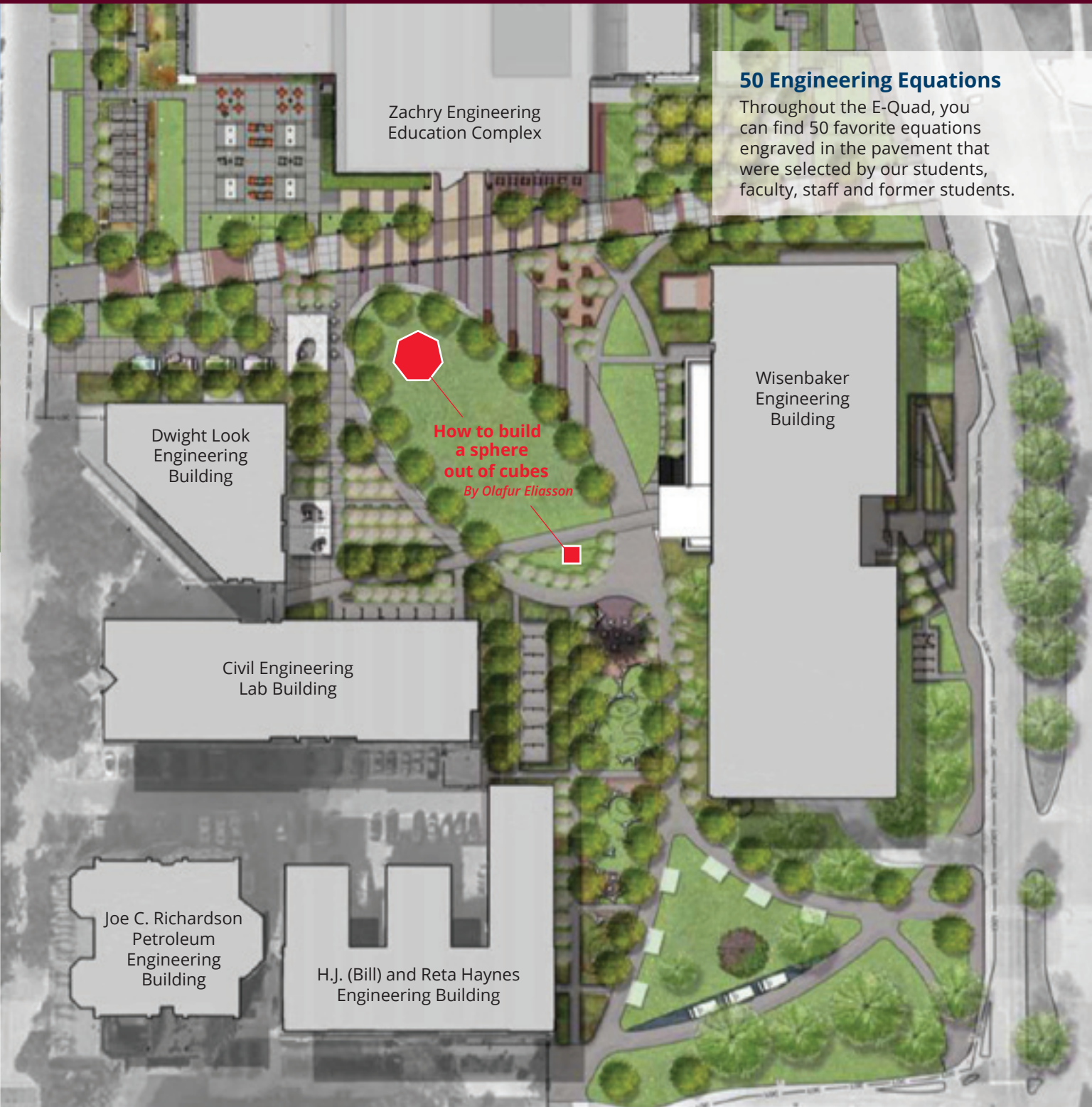

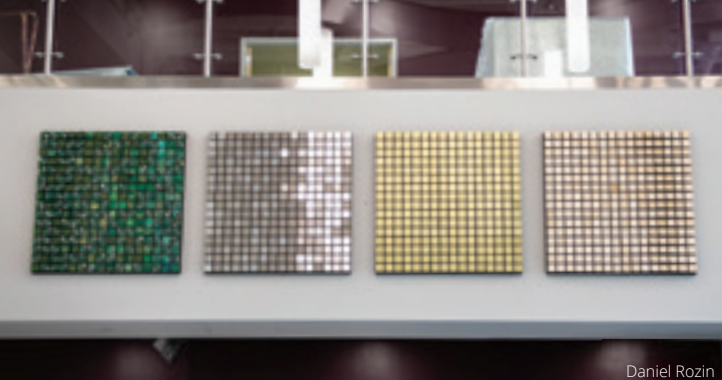

Daniel Rozin

INTERSECTION OF ART & ENGINEERING

The College of Engineering integrated an art program within the Zachry Engineering Education Complex to encourage creativity, innovation and promote cross-disciplinary initiatives in education and research. The art program entails site-specific works of art created by visionary artists, who conceptually draw inspiration from science, technology, engineering and mathematics. The goal of The College of Engineering art program is to engage the students, faculty and alumni by inspiring exploration, inventiveness and enterprise.



Jay Shinn

ENGINEERING ART COLLECTION

IN THE ZACHRY ENGINEERING EDUCATION COMPLEX

This collection celebrates the intersection of creativity and innovation through art and engineering. The College of Engineering has commissioned site-specific, privately-funded works of art that reflect the interdisciplinary fields of engineering.

A university committee selected 10 visionary artists from more than 100 candidates to be included in the art collection within the Zachry Engineering Education Complex. The selected artists draw inspiration from science, technology, engineering and mathematics. The collection promotes innovation and discovery of science and engineering by:

- Encouraging excellence, innovation and cross-disciplinary initiatives in engineering education
- Providing national and international leadership in engineering education
- Encouraging and supporting opportunities for students to grow beyond their chosen disciplines.



Copyright: How to build a sphere out of squares 2018, Olafur Eliasson for Texas A&M University — Photo: Studio Eliasson



Lyndi Sales



Rusty Scruby

Engineering Art Collection

LEVEL 1:

How to build a sphere out of cubes

By Olafur Eliasson

Mixed Media Sculpture (located in E-Quad)

Smoke Painting #44

By Rosemarie Fiore

Color Smoke Firework Residue on Paper

A-Gadda-Da-Vida

By Jay Shinn

Wall Painting with Choreographed Projected Color Sequence, Repeating Loop

LEVEL 2:

Pulse

By Daniel Canogar

Screens, Electronic Components, Video Contents

Prototype for Stellar Interloper (Silver Surfer)

By Iñigo Manglano-Ovalle

Carbon fiber and aluminum alloy-foil

What it Takes to Make

By Daniel Rozin

1024 motors, motion sensors, control electronics, custom firmware, printed circuits, stainless steel, brass and wood

Shapeshifting to Transcend Limbo & Transcending Realms: Chaos and Flow, Love and Fear

By Lyndi Sales

Mirrored acrylic, dichroic acrylic, and aluminum

Lathocyte

By Andy Vogt

Salvaged Lath

LEVEL 3:

Transparent Data

By Laurie Frick

Fused glass and mild steel

LEVEL 4:

Infinitesimals

By Rusty Scruby

Photographic reconstruction on aluminum

ZACHRY ENGINEERING EDUCATION COMPLEX



FACILITY MAP

Download the EngiNEAR ME app for fully accessible navigation around the ZACH.



el 1

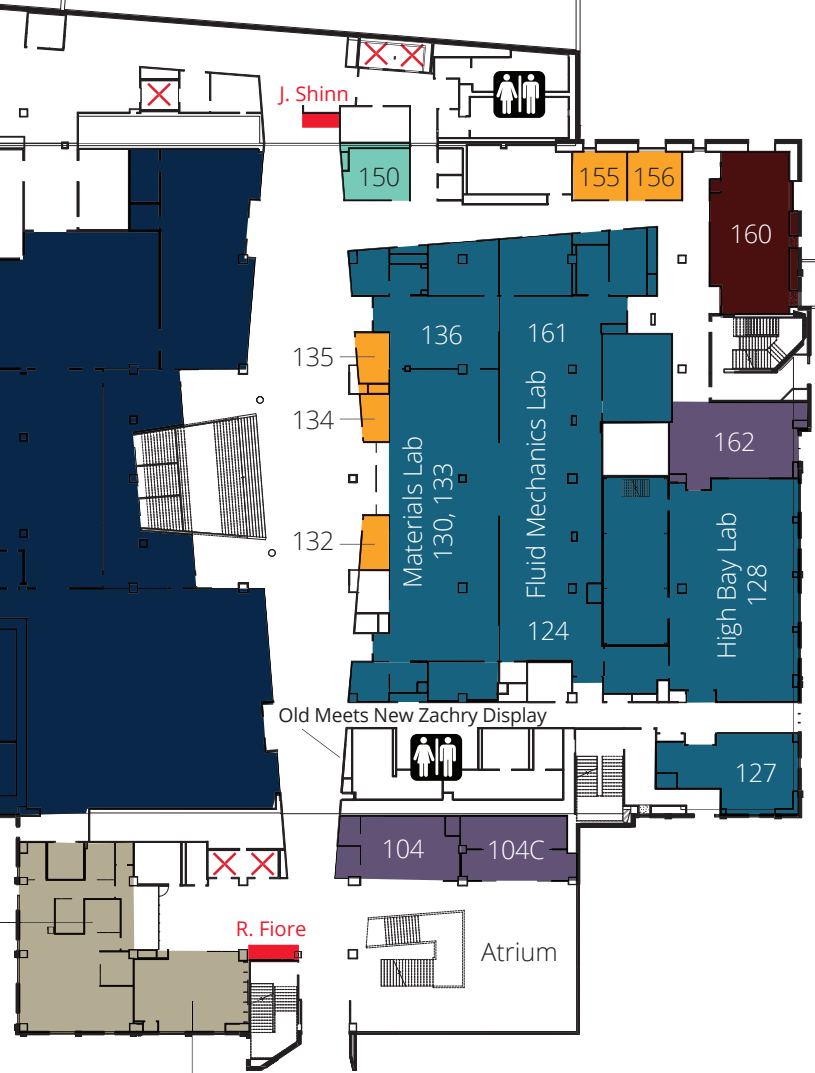

Level 2

- ✕ Elevators
- Design Studios
- Learning Studios
- Study/Huddle Spaces
- Open Study Areas
- Labs
- Learning Resource Center
- Event Space
- College of Engineering Offices
- Engineering Art Collection



Level 3



Level 4



Level 5

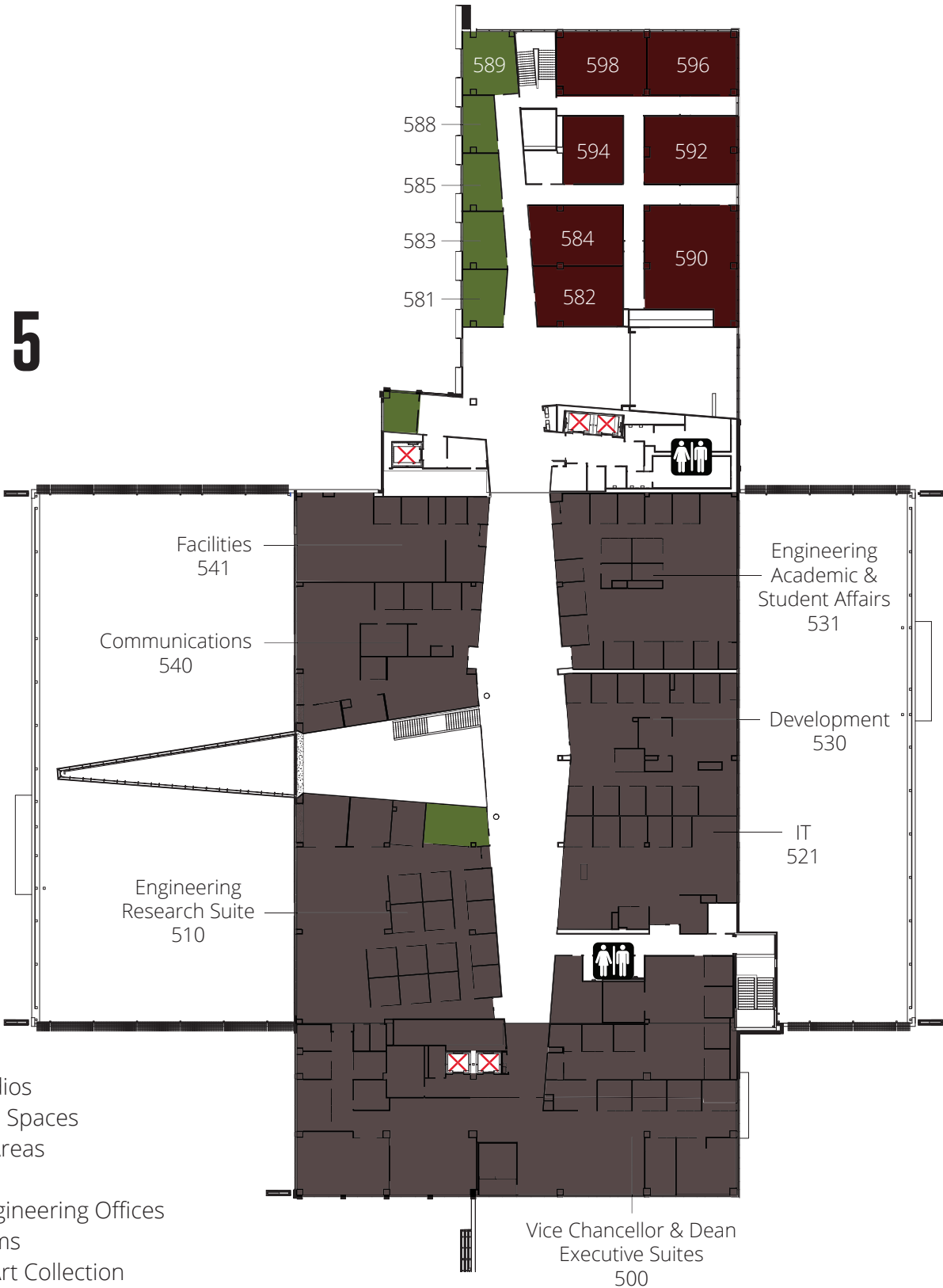

- ✕ Elevators
- Learning Studios
- Study/Huddle Spaces
- Open Study Areas
- Labs
- College of Engineering Offices
- Meeting Rooms
- Engineering Art Collection

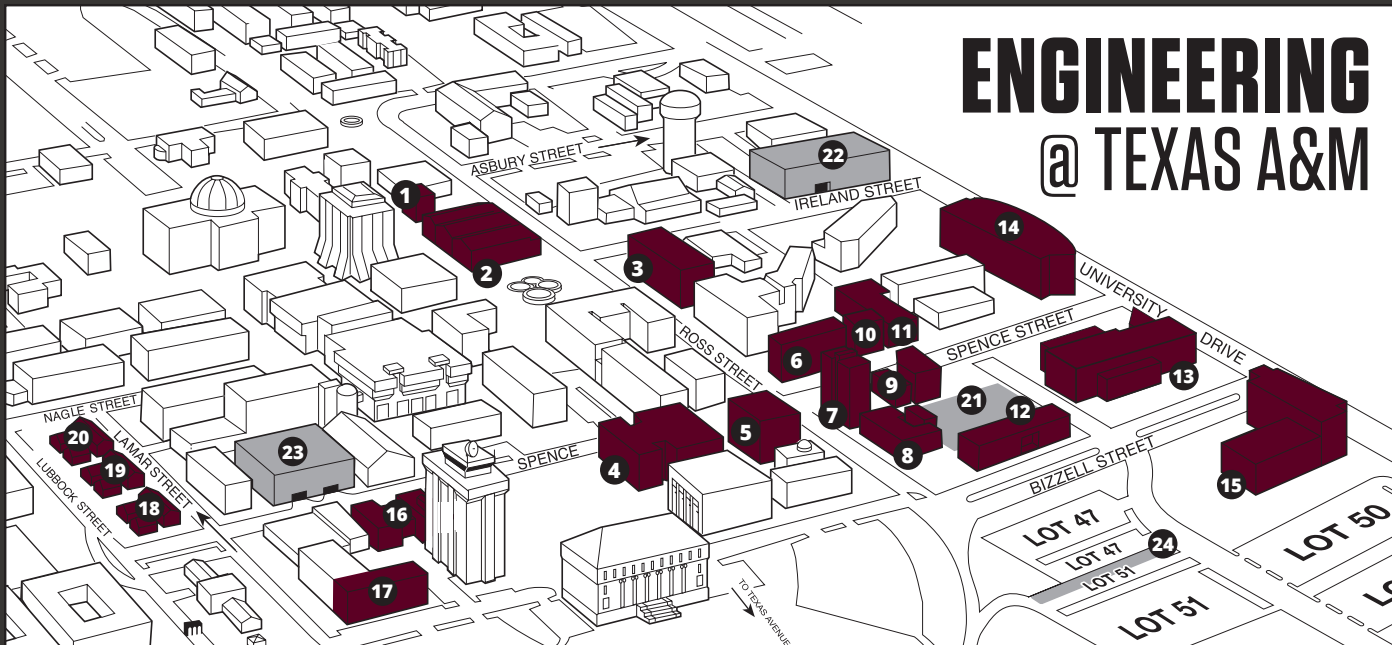

1 Fermier Hall (FERM)

466 Ross Street, College Station, TX 77843

2 Thompson Hall (THOM)

510 Ross Street, College Station, TX 77843

3 Reed McDonald Building (RDMC) / Graphics Services Building

575 Ross Street, College Station, TX 77843

4 Scoates Hall (SCTS)

333 Spence Street, College Station, TX 77843

5 Harvey R. Bright Building (HRBB)

710 Ross Street, College Station, TX 77843

6 Doherty Building (DRTY)

242 Spence Street, College Station, TX 77843

7 Joe C. Richardson Petroleum Engineering Building (RICH)

245 Spence Street, College Station, TX 77843

8 H.J. (Bill) and Reta Haynes Engineering Building (HEB)

727 Ross Street, College Station, TX 77843

9 Dwight Look Engineering Building (DLEB)

199 Spence Street, College Station, TX 77843

10 Mechanical Engineering Office Building (MEOB)

202 Spence Street, College Station, TX 77843

11 James J. Cain '51 Building (ENPH)

180 Spence Street, College Station, TX 77843

12 Wisenbaker Engineering Building (WEB)

188 Bizzell Street, College Station, TX 77843

13 Zachry Engineering Education Complex (ZACH)

125 Spence Street, College Station, TX 77843

14 Jack E. Brown Chemical Engineering Building (CHEN)

100 Spence Street, College Station, TX 77843

15 Emerging Technologies Building (ETB)

101 Bizzell Street, College Station, TX 77843

16 AI Engineering Building (AIEN)

423 Spence Street, College Station, TX 77843

17 Teague Research Center (TEAG)

735 Lamar Street, College Station, TX 77843

ENGINEERING ACTIVITIES BUILDINGS:

Located on Lamar Street between Spence Street and Nagle Street.

18 Engineering Activities Building A (EABA)

646 Lamar Street, College Station, TX 77843

19 Engineering Activities Building B (EABB)

620 Lamar Street, College Station, TX 77843

20 Engineering Activities Building C (EABC)

588 Lamar Street, College Station, TX 77843

21 Engineering Quad (E-Quad)

VISITOR PARKING:

22 Northside Parking Garage (NSPG)

104 Ireland Street, College Station, TX 77843

23 Central Parking Garage (CCPG)

450 Spence Street, College Station, TX 77843

24 Lot 51 Paid Visitor Parking

Polo Road, College Station, TX 77843